

WARING COMMERCIAL

Europe Medium Duty Bar Blender
with Electronic Keypad &
48 oz. Stainless Steel Container

BB320SE

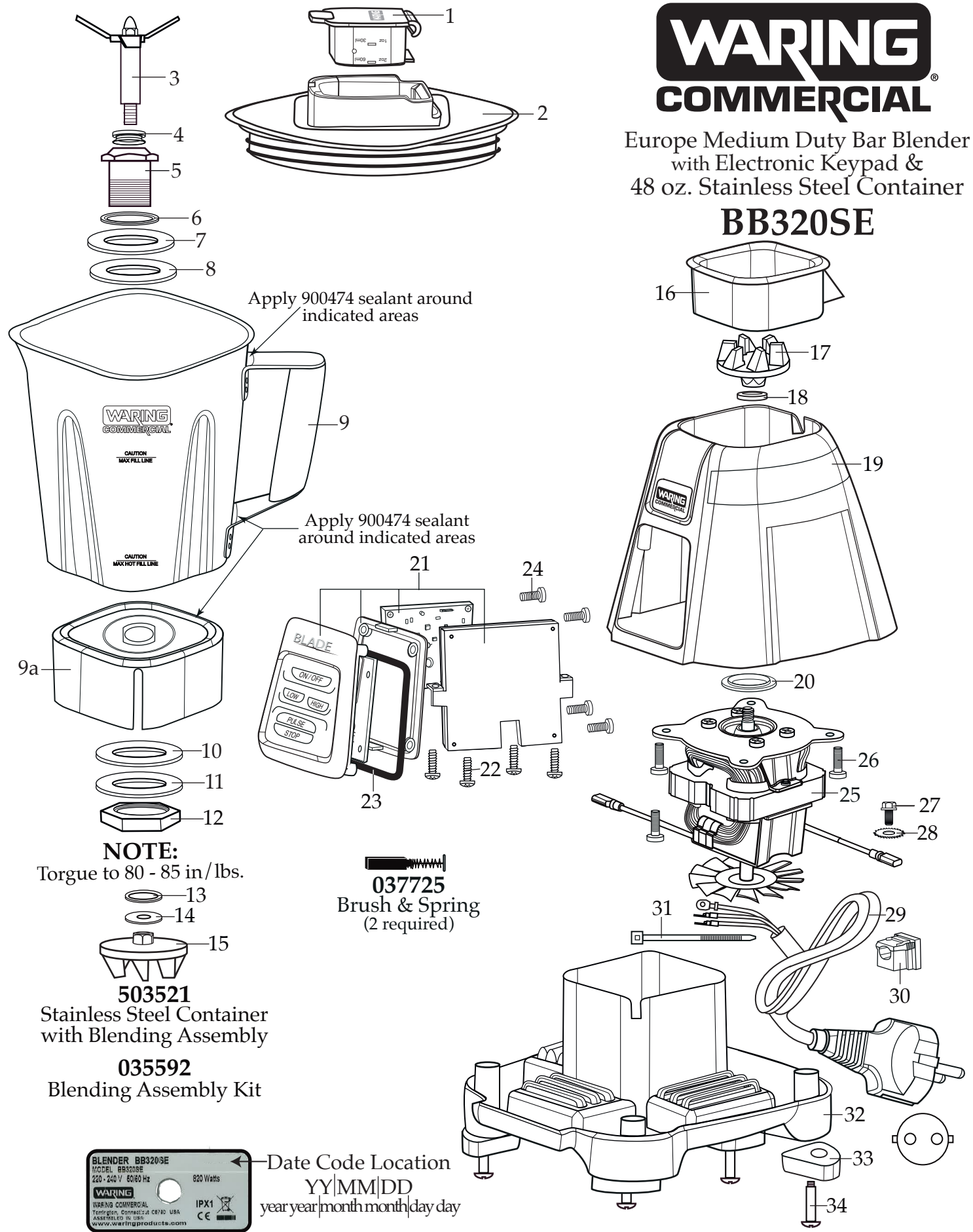

Apply 900474 sealant around indicated areas

Apply 900474 sealant around indicated areas

NOTE:
Torque to 80 - 85 in/lbs.

037725
Brush & Spring
(2 required)

503521
Stainless Steel Container
with Blending Assembly

035592
Blending Assembly Kit



Date Code Location
YY|MM|DD
year|month|month|day|day

Illustration #	Part #	Description
1	035153	Jar Cover Lid
2	036319-P 033625-M	Polyone Jar Lid (<i>on units after 2/1/2020</i>) Monprene Jar Cover
3	503444	Blade Assembly
4	027716	V Seal
5	503458	Bearing Holder/Seal Assembly
6	009724	Nylon Flat Washer
7	003537	Stainless Steel Washer
8	003509	Neoprene Washer (rubber)
9	034775	48 oz. Stainless Steel Container
9a	034776	Jar Bottom
10	003509	Neoprene Washer (rubber)
11	003537	Stainless Steel Washer
12	034156	Bearing Holder Nut
13	003526	Phenolic Washer
14	035048	Flat Stainless Steel Washer
15	503520	Coupling
16	033623	Jar Pad
17	503520	Coupling
18	035756	Stainless Steel Cap Washer
19	033616	Top Housing
20	026269	Upper Motor Mount
21	035416	PCB Control Panel
22	033526	Screw (4 required)
23	033737	O Ring
24	026267	Screw (4 required)
25	035170	230 volt Chiaphua Motor
26	032611	Screw (4 required)
27	027278	Ground Screw (2 required)
28	002943	Washer (2 required)

Illustration #	Part #	Description
29	503490	Cordset Assembly
30	033619	Strain Relief
31	013731	Wire Tie (2 required)
32	035282	Bottom Housing
33	035287	Foot (4 required)
34	035260	Screw (4 required)

